

# LUMI G1

Tri-mode wireless gaming mouse with charging dock

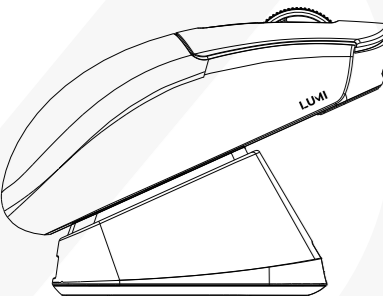

## INSTRUCTION MANUAL

### WELCOME TO MOXANIC

MOXANIC diciptakan dengan pendekatan yang berfokus pada kualitas, ketelitian, dan konsistensi. Setiap detail dirancang dengan tujuan yang jelas untuk menghadirkan pengalaman yang solid, relevan, dan dapat diandalkan.

Kami percaya bahwa hal-hal yang dirancang dengan baik akan terasa natural saat digunakan. Tanpa perlu penjelasan berlebihan, MOXANIC hadir sebagai bagian yang menyatu dalam keseharian.

### INTRODUCTION

Thank you for choosing MOXANIC LUMI G1. This product is designed to provide a balance of performance, comfort, and usage flexibility across various scenarios.

LUMI G1 supports three connection modes and is equipped with a responsive control system to ensure a stable and precise user experience. With its compact design, lightweight build, and integrated supporting features, LUMI G1 is built for comfortable long-term use.

This guide contains information on functions, settings, and safe usage of the device. Please read this manual carefully before use to ensure optimal performance and durability.

### SPECIFICATION

SPECIFICATION	MOXANIC LUMI G1
SIZE / DIMENSIONS (L×W×H)	117 × 62 × 38 mm
SHELL MATERIAL	ABS
SENSOR	PixArt PAW3311
MCU	Broadcom BK3633
TRACKING SPEED	400 IPS
ACCELERATION	40G
MAX DPI	Adjustable up to 24,000 DPI
WEIGHT	±59.8 g
MICRO SWITCH	80 million clicks lifespan
SCROLL ENCODER	300,000 cycles lifespan
CONNECTIVITY	Wired (USB Type-C) / 2.4G Wireless / Bluetooth
POLLING RATE	Up to 1000 Hz (Wired & 2.4G)
BLUETOOTH POLLING RATE	133 Hz
BATTERY CAPACITY	300 mAh
RGB LIGHTING	Supported

### BUTTON FUNCTION DESCRIPTION

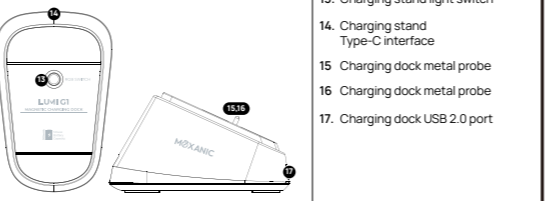
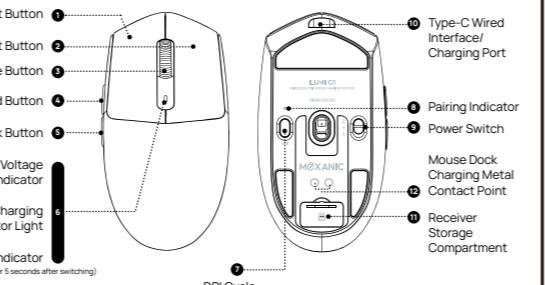

### NOTES:

#### Sleep Mode

- **Light Sleep:** The mouse enters light sleep mode immediately upon inactivity.
- **Deep Sleep:** The mouse enters deep sleep after 10 minutes of inactivity. This duration can be adjusted within the driver software.

#### Sleep Wake Up Method

- **Wake-up Method:** The mouse uses "Motion Wake-up," meaning it wakes up immediately when moved.
- **Note:** To wake the mouse from deep sleep, simply move the mouse or press any button.

#### Hardware Connection

- **Connection:** Plug the product's USB connector into a USB 1.1 or later port.
- **Installation:** An automatic hardware installation prompt will appear in the lower right corner of the computer during the first use.
- **Wired Mode:** Plugging in the data cable will default the device to wired mode and initiate charging.

### CONNECTION MODE

#### Bluetooth Connection Method:

- Switch Mode:** The power switch must be set to the Bluetooth (BT) position. The mode indicator will show a blue light.
- Pairing:** Press and hold the bottom "7" button for 3 seconds. The indicator will flash blue rapidly to signal pairing mode.
- Connect:** On your device (PC/Phone), search for "LUMI G1" and select it to connect.
- Success:** Once connected, the indicator stays blue for 1 second and then turns off.

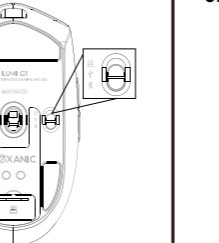

#### Wireless Dongle 2.4G Method:

- Switch Mode:** Move the power switch to the 2.4G position.
- Forced Pairing:** If needed, press and hold the "7" button for 3 seconds until the light flashes red rapidly, then insert the receiver.
- Success:** After a successful pairing, the red indicator stays on for 1 second before turning off.

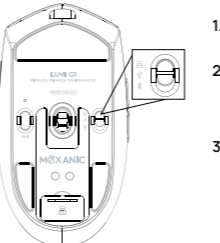

### 3. Wired Mode Connection Method

- Connection:** Plug the provided Type-C data cable into the mouse and your computer.
- Automatic Switching:** The mouse will automatically default to wired mode and begin charging its internal battery simultaneously.
- Usage:** You can use the mouse normally while it is connected via cable.

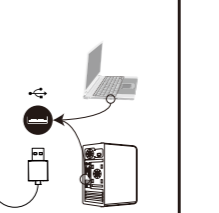

⚠ When using the mouse in wired mode, we recommend switching the power to the Middle (OFF) position.

#### Package Contents

- LUMI G1 Tri-mode Gaming Mouse
- Magnetic Charging Dock
- USB Receiver
- Type-C Data Cable
- Instruction Manual
- Grip Tape

### PRECAUTIONS:

- ⚠ Do not immerse or splash the mouse with liquid.
- ⚠ Do not use in high temperature or high humidity environments.
- ⚠ Do not place the mouse in an open flame.
- ⚠ Do not smash, crush, or disassemble the mouse.
- ⚠ Do not use a fast charging adapter to charge the mouse or the dock.