



INNO X2M

TRI MODE  
MAGNESIUM MOUSE



English

Thank you very much for purchasing our VortexSeries product, and hope it can bring you a new operation and feeling. At the same time, we look forward to getting your valuable suggestions on our product, and we will continue to provide you with better products and services.

### Product Description

1. Product model : INNO X2M
2. Product interface type : USB-Type-C
3. Product connection method : USB, 2.4G, Bluetooth
4. Product optical sensor : Original phase PAW3395
5. Rate of return (HZ) :  
2.4G mode : 125/250/500/1000 default /2000/4000/8000HZ (adjustable)  
Wired mode : 125/250/500/1000HZ default (adjustable)  
Bluetooth mode : 125HZ (not adjustable)
6. Frame rate (IPS) : 650IPS
7. Maximum acceleration (G) : 50G
8. DPI value and corresponding color : 800 (red) - 1200 (green) - 1600 (blue) - 3200 (light blue) - 5600 (yellow) - 26000 (purple)
9. Battery capacity : 230mAh
10. Charging voltage : 5V
11. Product weight : ≈ 45±3g
12. Product size : 119.5\*61\*36.3mm
13. Data cable interface (length) : Type-C/ 1.5 meters
14. Wireless transmission distance : 10 meters
15. Switch brand and service life : KAILH 100 million times
16. Various operating system : XP, Win7, Win8, Win10, Win11, Mac OS, Android, Linux, Etc.
17. Sleep mode current ; 60uA

### PACKING LIST

- Mouse\*1    2.4G Dongle\*1    Cable\*1    Instruction Manual\*1
- Grip Tape\*1    Adapter\*1    Mouse Feet\*1

### Button Function Description

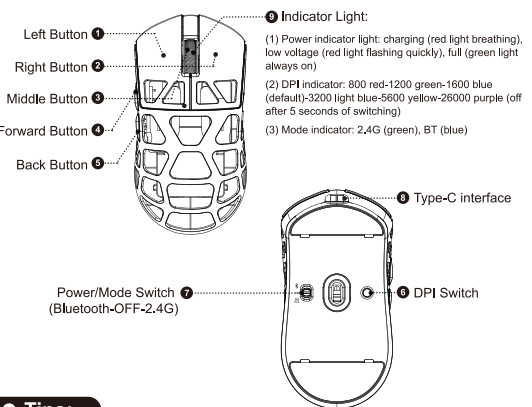

### Tips:

1. **Sleep mode** : The mouse stops working and enters sleep mode after 30 second
2. **Sleep wake-up method** : Key wake-up
3. **Hardware connection** : insert the product's USB plug into the USB 1.1 or above port (when the product is used for the first time, an automatic hardware installation prompt will pop up in the lower right corner of the computer)

### Connection mode

#### 1. Bluetooth connection method:

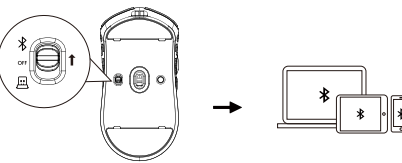

1. The power switch must be in the Bluetooth segment, and the Bluetooth mode light is blue; at that time, please turn on the Bluetooth of your mobile phone or other device that needs to be paired to search. When "INNO X2M" appears, please connect in time. After the connection is successful, the code matching light will stay on blue for about 2 seconds, and then go out.
2. If you need to perform Bluetooth pairing again, press and hold the "①", "②", and "③" keys at the same time for about three second. The Bluetooth mode light will flash blue quickly. At that time, please turn on the Bluetooth of your mobile phone or other device that needs to be paired to search, when "INNO X2M" appears, please connect in time After the connection is successful, the pairing light will stay on blue for about 1 second, and then turn off.

#### 2. 2.4G Connection method:

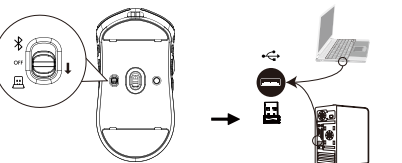

1. When you want to use the 2.4G channel of the mouse, turn the power switch to the 2.4G position and the green light will flash. Then take out the 2.4G receiver of the mouse and plug the receiver into the free USB port of the computer. At this time, the computer will automatically install the configuration software. When the computer prompts that the installation is complete and can be used, the green light will stay on for 1 second, and the mouse can be connected to the computer. If the computer does not respond when you plug in the receiver, you need to change another USB port. At this time, the computer will automatically code and install the corresponding adaptation software. Generally, the computer will prompt: The installation is complete and can be used which means that the mouse is the same as the computer 2.4G Coding was successful.
2. If there is a connection failure or signal loss in the 2.4G signal, turn the power switch to the 2.4G position, then take out the mouse 2.4G receiver, plug the receiver into a free USB port on the computer, and press and hold "①", "②", and "③" at the same time. After pressing for about three seconds, the 2.4G channel light will flash green quickly. When the pairing is successful, the light will stay on green for 2 seconds and then go out, and the mouse can be used normally. If pairing fails within 120 seconds, please repeat the above operation.

#### 3. Wired mode connection method:

Use the included TYPE-C cable to connect to the computer. When the cable is plugged in, switch the mouse to "OFF" for wired mode. Move the mouse and the computer screen pointer can move, and the mouse can be used normally.

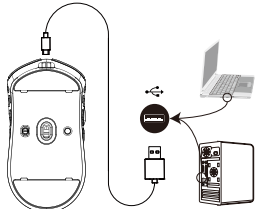

### PRECAUTIONS

- ⚠ It is forbidden to immerse the mouse in liquid or spray the mouse with liquid
- ⚠ It is forbidden to use the mouse in high temperature and high humidity environment
- ⚠ Do not place the mouse in an open flame
- ⚠ Violence against pressing the mouse is prohibited
- ⚠ Do not disassemble the mouse

